



# Micro Inverter

300 / 400 / 800

Eco Green Energy has designed its micro inverter series to provide versatility, durability and high performance for any of your projects. Certified by international standards, our micro inverters will enable you to have full control of you project will delivering the best power output.

## FEATURES & BENEFITS

- Easy installation
- High performance maximum power point tracking (MPPT)
- Low maintenance costs
- Reverse power transmission



EXTERIOR

### ACCESSORIES



ANTENNA



SCREW KIT



USER MANUAL



AC PLUG

**Module**

**WVC-300**

Recommend use panels	1*375Watt
Output voltage mode	120/230V Auto switch
PV Open circuit voltage	33-60VDC
Operating voltage range	22-60V
Starting voltage range	22-60V
Short-circuit current	15A
Maximum working current	13.7A



**EGE-WVC-300(Life)**

**Output parameters**

**@120V**

**@230V**

Recommend use panels	310Watt	310Watt
Output voltage mode	300Watt	300Watt
PV Open circuit voltage	2.5A	1.3A
Operating voltage range	85-160VAC	180-280VAC
Starting voltage range	48-51Hz/58-61Hz	48-51Hz/58-61Hz
Short-circuit current	>95%	>95%
Maximum working current	15PCS (Single)	25PCS (Single)

**Output efficiency**

**@120V**

**@230V**

Static MPPT efficiency	99.5%	99.5%
Max output efficiency	95%	95%
Loss of power at night	<0.5W	<0.5W
Total current harmonics	<5%	<5%

**Appearance and technical features**

Temperature range	-20°C to +50°C
Size (L×W×H)	165mm×176mm×38mm
Net amount	0.82kg
Waterproof grade	Ip65 NEMA3R
Heat dissipation mode	Self-cooling
Communication mode	Wi-Fi
Power transmission mode	Reverse transmission,Load priority
Monitoring system	APP
Electromagnetic Detection	EN61000-6-1:2007 ;EN6100-6-3:2007+A1:2011+AC:2012
Power Grid standard	EN50549-1、 EN 50549-2、 NBR 16149:2013、 UL1741
Power grid detection	IEC/EN 62109-1、 IEC/EN 62109-2、 IEC 62116、 IEEE 1547
Certificate	CE.Patented technology

**Packing weight**

Specifications	Each(Packing)	Box(15PCS)
Weight	1.28KG	19.5KG
Size	245×202×60mm	450×395×345mm

**Module**

**WVC-400**

Recommend use panels	1*475Watt
Output voltage mode	120/230V Auto switch
PV Open circuit voltage	33-60VDC
Operating voltage range	22-60V
Starting voltage range	22-60V
Short-circuit current	18A
Maximum working current	16A



**EGE-WVC-400(Life)**

**Output parameters**

**@120V**

**@230V**

Recommend use panels	400Watt	400Watt
Output voltage mode	380Watt	380Watt
PV Open circuit voltage	3.33A	1.73A
Operating voltage range	85-160VAC	180-265VAC
Starting voltage range	48-51Hz/58-61Hz	48-51Hz/58-61Hz
Short-circuit current	>95%	>95%
Maximum working current	15PCS (Single)	25PCS (Single)

**Output efficiency**

**@120V**

**@230V**

Static MPPT efficiency	99.5%	99.5%
Max output efficiency	95%	95%
Loss of power at night	<0.5W	<0.5W
Total current harmonics	<5%	<5%

**Appearance and technical features**

Temperature range	-20°C to +50°C
Size (L×W×H)	165mm×176mm×38mm
Net amount	0.82kg
Waterproof grade	Ip65 NEMA3R
Heat dissipation mode	Self-cooling
Communication mode	Wi-Fi
Power transmission mode	Reverse transmission,Load priority
Monitoring system	APP
Electromagnetic Detection	EN61000-6-1:2007 ;EN6100-6-3:2007+A1:2011+AC:2012
Power Grid standard	EN50549-1、 EN 50549-2、 NBR 16149:2013、 UL1741
Power grid detection	IEC/EN 62109-1、 IEC/EN 62109-2、 IEC 62116、 IEEE 1547
Certificate	CE,CEC, ETL

**Packing weight**

Specifications	Each(Packing)	Box(15PCS)
Weight	1.28KG	19.5KG
Size	245×202×60mm	450×395×345mm

**Module**

**WVC-800**

Recommend use panels	2*475Watt
Output voltage mode	120/230V Auto switch
PV Open circuit voltage	33-60VDC
Operating voltage range	22-60V
Starting voltage range	22-60V
Short-circuit current	2*18A
Maximum working current	2*16A



**EGE-WVC-800(Life)**

**Output parameters**

**@120V**

**@230V**

Recommend use panels	800Watt	800Watt
Output voltage mode	780Watt	780Watt
PV Open circuit voltage	6.7A	3.5A
Operating voltage range	85-160VAC	180-265VAC
Starting voltage range	48-51Hz/58-61Hz	48-51Hz/58-61Hz
Short-circuit current	>95%	>95%
Maximum working current	6PCS (Single)	12PCS (Single)

**Output efficiency**

**@120V**

**@230V**

Static MPPT efficiency	99.5%	99.5%
Max output efficiency	95%	95%
Loss of power at night	<0.5W	<0.5W
Total current harmonics	<5%	<5%

**Appearance and technical features**

Temperature range	-20°C to +50°C
Size (L×W×H)	283mm×200mm×41.6mm
Net amount	1.56kg
Waterproof grade	Ip65 NEMA3R
Heat dissipation mode	Self-cooling
Communication mode	Wi-Fi
Power transmission mode	Reverse transmission,Load priority
Monitoring system	APP
Electromagnetic Detection	EN61000-6-1:2007 ;EN6100-6-3:2007+A1:2011+AC:2012
Power Grid standard	EN50549-1、 EN 50549-2、 NBR 16149:2013、 UL1741
Power grid detection	IEC/EN 62109-1、 IEC/EN 62109-2、 IEC 62116、 IEEE 1547
Certificate	CE,CEC, ETL, INMETRO

**Packing weight**

Specifications	Each(Packing)	Box(15PCS)
Weight	2.8KG	14KG
Size	342×240×115mm	440×380×260mm

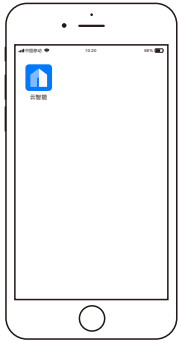

## DOWNLOAD Cloud Intelligence APP

Please use the QR code to scan and install the "Cloud Intelligence" client application, System version: Android 5.0, IOS 9 and above



### Note

Please strictly observe the following installation conditions

- Connect the communication antenna on the inverter;
- Install the inverter in a place where the Wifi signal is well covered;
- The connected Wi-Fi network needs to be in 2.4G communication mode;
- If the WiFi signal cannot effectively cover the inverter, an additional WiFi signal booster can be installed;
- Turn on the Bluetooth of the mobile phone;

### HELP Features

Smart APP can realize real-time data transmission with the cooperation of Alibaba Cloud IoT. Through graphs and graphic displays in time, users can understand the operation of the power station. The user can monitor the operation and adjust the output power function of the system.

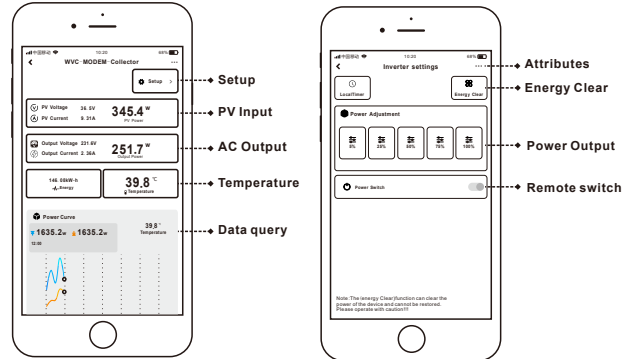

### Cloud Intelligence APP



**INTELLIGENT IoT MONITORING MODEM**  
Number of data collectors per Modem  
Built-in WiFi IoT data terminal  
Can be used on any smart device (Android/iOS)

- CO-2 induced environmental analysis
- Daily and total energy generation in kWh
- Actual DC input voltage, current and power
- Actual AC output voltage, current and power
- Inverter temperature
- Historical (daily, weekly, monthly) power curve
- Power losses due to weather induced effects
- Optional limitation of power output
- Online switch for the inverter start stop

### Bluetooth Mode

#### Setp 1

Turn on the Bluetooth of the mobile phone, click the "+" icon to add the device;

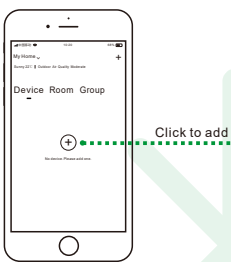

#### Setp 2

When the inverter appears on the automatic discovery page, click the "+" sign

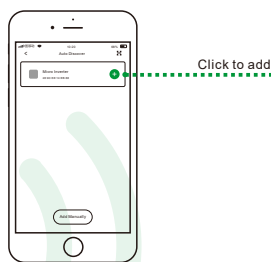

#### Setp 3

Select WiFi signal, enter the Wi-Fi password; click Next



#### Setp 4

The system will enter the network configuration state

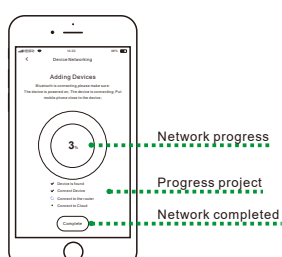

### Wi-Fi Mode

#### Setp 1

Bluetooth distribution network fails, you can click to scan the QR code to operate



#### Setp 2

Scan the QR code on the inverter to activate network operation

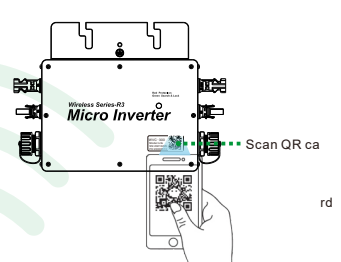

#### Setp 3

Select WiFi signal, enter the Wi-Fi password; click Next

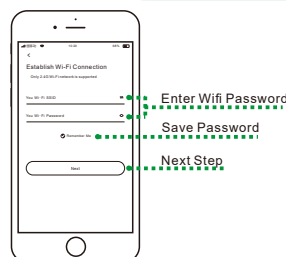

#### Setp 4

The system will enter the network configuration state



# Warranty card

## MICRO INVERTER



### Customer information

Name:

---

Address:

---

Tel:

E-mail:

---

### Product and fault information

Serial number:

---

Model number:

---

Date of purchase:

Date of installation:

---

Load type and load power:

---

Time of product failure:

---

Product failure description:

---

#### The following situations are out of warranty:

- 1) Warranty card or serial number is missing
- 2) Human error
- 3) Warranty expired
- 4) Damage or loss caused by external causes due to force majeure
- 5) Disassemble or modify without authorization from the supplier
- 6) Violation machine operation / terms of use (such as continuous overloading, wrong battery input voltage)

Customer signature:

Date: